

At End Of Day:**Releasing Steam Pressure**

To prolong the life of the boiler and its components, we recommend performing this task at the end of each day.

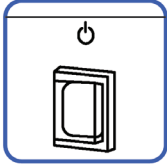

1. Turn off the boiler switch.



2. Press the steam button on your steam accessory until the pressure drops to zero.

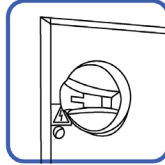

3. To complete the shutdown of the boiler, turn the main switch off.

Every Week:**Flushing The Boiler Out**

To prevent limescale deposits, the boiler should be drained once per week.



1. Should be completed in the morning or when the boiler is cold with zero pressure.

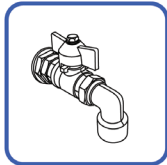

2. Open the drain valve and allowing the water to fully empty into a large container.

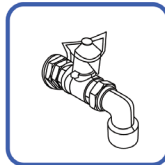

3. Once done, close the drain valve.

Caution:

The drain valve may still be hot. Always use protective gloves and allow sufficient cooling time before opening.

Every Month:**Cleaning the Pump Intake Filter**

The pump intake contains a small water filter designed to prevent coarse particles from entering the pump. Regular cleaning will help maintain performance.

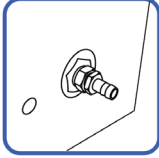

1. Locate the hose holder and identify the pump intake connection.

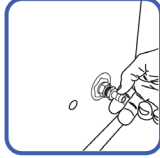

2. Unscrew the two-piece connection at the pump intake.



3. Carefully, remove the filter.

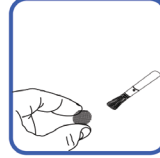

4. Use a soft brush to remove any scale or debris, taking care not to damage the fine mesh inside the filter.



5. Reassemble the connection securely. Test for leaks.